



Installation Instructions

Complete set active Sound incl. Soundbooster

Mercedes SLK R172

v1.2 (16.06.2017)

Contents

1	Liability Exclusion	3
2	Copy Right	4
3	General Notes	4
4	Safety instructions	5
5	Requirements for the determinable operation	5
6	Note	5
7	How to connect a cable to another	6
8	Note Cable Inscription/Color	7
9	Assembly Instructions	8
10	Removing trim panel of the dashboard	9
11	Removing driver's seat	10
12	Connection cable set	11
13	Removing center console	12
14	Removing center console	13
15	Connection ignition lead	14
16	Installation pushbutton / routing connecting cable sound generator	15
17	Routing connecting cable sound generator	16
18	Installation sound generator	17
19	Important Information Sound Booster	18

1 Liability Exclusion

Dear Customer

Our cable sets are developed according to the connection- and circuit diagrams of the corresponding car manufacturer. Before the original production the cable sets will be tested on an original car. Therefore, the integration into the car electronics will be executed according to the instructions of the manufacturer. Regarding the necessary pre-understanding and the accuracy of the presentation of texts and pictures our mounting guidelines correspond to the usual ones in car technology and car electronics. Practically, they have been proved one's worth a hundred times.

However, should there be any difficulties during the installation of our products we will be at your disposal any time for support by phone or by mail. Moreover, we offer you to execute the installation at our works in Bad Segeberg.

Costs which may arise because a third person will execute the installation of our products will not be supported by us in any case. Only if there is a mistake caused by our product we will pay the proved costs of the installation as well as the costs of the removal of the defective product. The refund of expenses will be limited to gross EUR 110,- ; we reserve the right to check the described mistake in our works in Bad Segeberg. In case of a proved reclamation the costs for dispatch for the check in our factory will be transferred to you.

According to our experience each specific factory which has the necessary diagnostic device, diagnostic software and the circuit diagrams of the manufacturer can find possible mistakes at our products within a short time. So the installation and removal including diagnostic inspection can be realised in at most 60 minutes.

We also made the experience that many specific factories cannot work with the circuit diagrams of the manufacturer, and that they cannot read usual wiring diagrams. Therefore, very easy installation works will take many hours. You will understand that we neither take the risk to find a reliable specific factory nor the financing of the training of the staff of your favoured factory.

Costs which will arise because you buy missing parts or spare parts at other suppliers will be refunded by us up to the amount of the costs which had been arisen by additional supply (saved expenses). In this case, there would be no right for refund according to the legal guarantee right as long as we have no deadline for supplementary performance or a deadline for supplementary performance has not expired.

So if you have any problems with the installation or operation of one of our products please call us, send us an email, send us the product or take your car to our factory in Bad Segeberg. We are sure to find an appropriate solution for each concern.

With best regards
Your Kufatec GmbH & Co. KG Team

2 Copy Right

Our installation- and removal instructions, installation plans, software and other documentation with texts or pictures are protected by copy right.

A publication or distribution of these documents is only permitted with a written approval of Kufatec GmbH & Co. KG.

3 General Notes

Regarding the development there has especially been paid attention to your personal safety together with the most possible operating comfort, modern design and actual product technologies.

Despite most possible accuracy in case of incorrect installation or use or in case of incorrect operating, it is possible that injuries or damages of property may arise.

Therefore, please read the operating instructions you have received carefully and completely, and keep it with you.

All articles of our production will be checked at 100% — for your safety.

We reserve the right to make technical changes which serve the progress at any time.

Before the installation or startup it may be necessary, depending on the article and purpose of use, to check the legal instructions of each country.

In case of warranty claim the device has to be sent to the seller originally packed together with the sales receipt and a detailed description of the mistake. Please consider the manufacturer's instructions for return (RMA). The legal warranty instructions are valid.

The warranty claim and also the permission for startup will expire in case of:

- unauthorised changes on the device or the accessories which have not been executed or approved by the manufacturer or its partners
- opening of the box
- repair of the device on your own
- incorrect use / no normal use / startup
- influence of force on the device (falling down, wilful damage, accident, etc.)

During the installation please consider all safety and legal instructions. The device may only be installed by trained qualified personnel or persons who are similar qualified.

In case of installation- or function problems please reduce the search of the mistake to approx. 0,5 hours for mechanical works or 1,0 hours for electronic works.

To avoid unnecessary additional work and expenses, please send immediately an inquiry to our technical support with the Kufatec contact form (<http://www.kufatec.de/shop/de/infocenter/>)

Please absolutely mention the following:

- car chassis number
- part number of the add-on kit
- exact description of the problem
- work steps already made

4 Safety instructions

The installation may only be executed by trained qualified personnel. Please execute the installations only in a condition of dead voltage. Here please separate for example the battery from the main power supply and consider the instructions of the car manufacturer.

- In order to not endanger your own driving safety please never use security relevant screws, bolts or other fixation pieces at steering, brake system or other components.
- Connect the device only at 12V wiring system voltage with ground connection to the autobody. This assembly is not allowed for the use in trucks or other cars with 24V wiring system voltage.
- Please avoid the installation of the device at positions where the driving safety or the functional efficiency of other subassembly integrated in the car are restricted.
- This module may only be used together with the following mentioned car types and models; the installation may be executed exclusively by use of the circuit points mentioned in the assembly instructions.
- Kufatec GmbH & Co. KG does not assume liability for damages which are caused by incorrect installation, the use of inapplicable circuit points or the installation into car types and -modules which are not foreseen.
- We would like to draw your attention to the fact that the module processes the data of the MOST-protocol of the car mentioned below. Therefore, during the installation of the module it will be used a model-specific complete system which we as the manufacturer of the mentioned construction line only know partly.
- Especially in case of changes within the same model line and the same year we therefore cannot guarantee the applicability of our construction line in each case. Kufatec GmbH & Co. KG does not assume liability for the applicability of our construction line with changes made by the manufacturer.
- Kufatec GmbH & Co. KG does not assume liability that the installation of the here described component has been permitted according to the guarantee instructions of particular car manufacturers. Therefore, please consider the guidelines for installation and guarantee conditions of your car manufacturer before installation.
- The manufacturer reserves the right to change components without giving reasons.
- Subject to errors and changes

5 Requirements for the determinable operation

Please use the device only in its the corresponding area.

In case of unprofessional and untypical use, installation or modification the permission for operation and the warranty claim will expire.

6 Note

Make sure that there's enough space at the described position. If there is no space please cancel the installation and contact our technical support.

The use of a sound booster is not permitted without registration in the vehicle papers, in the area of the german StVZO. The noise emission of the vehicle is increased by this retrofit. The regulations of the StVZO must be observed. It is therefore recommended to ask for a specific registration option at the responsible TÜV/DEKRA office before retrofitting. Outside Germany, please observe the laws on vehicle licensing applicable in your country.

7 How to connect a cable to another

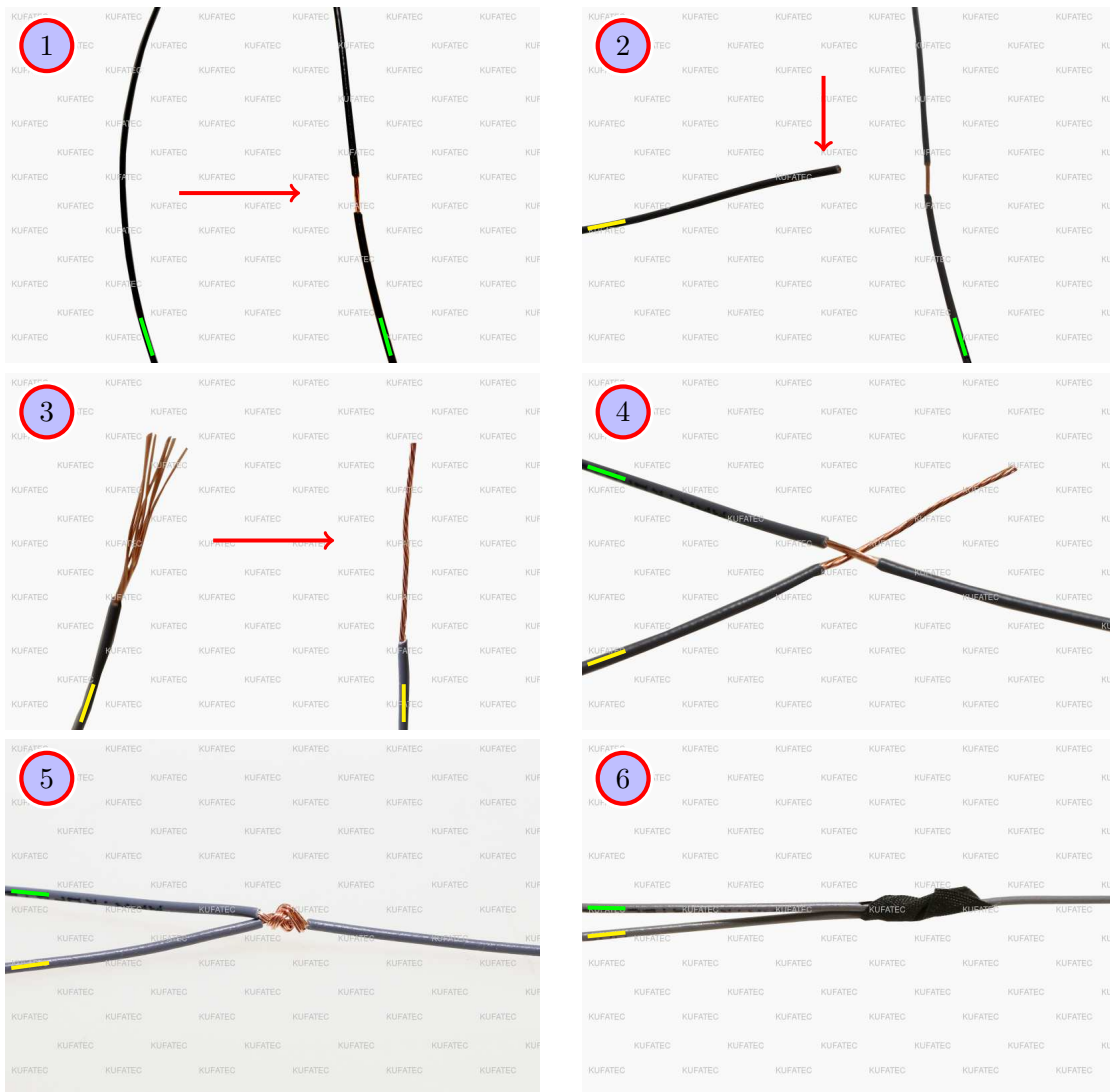

Figure 1: How to connect a cable to another

Table 1: How to connect a cable to another

No.	Work step	Note
1	Take the cable of the vehicle, to which you want to connect, (green marked here) and strip the insulation at one point with a suitable tool (cable stripper/cutter knife).	
2	Now take the cable of the cable set, which you want to connect, (yellow marked here) and strip the insulation at the end.	
3	Twirl the wires of the stripped cable together.	
4	Place the end of the cable you want to connect under the stripped point of the cable of the vehicle...	
5	... and wrap the cable you want to connect around the cable of the vehicle.	
6	Lastly, stick insulating tape around the connection point.	

8 Note Cable Inscription/Color



Figure 2: Cable Inscription

If our cable set consists exclusively of grey wires, connect the wires according to the cable inscription.

9 Assembly Instructions

The following illustration shows the cable routing as well as the position of the individual components.

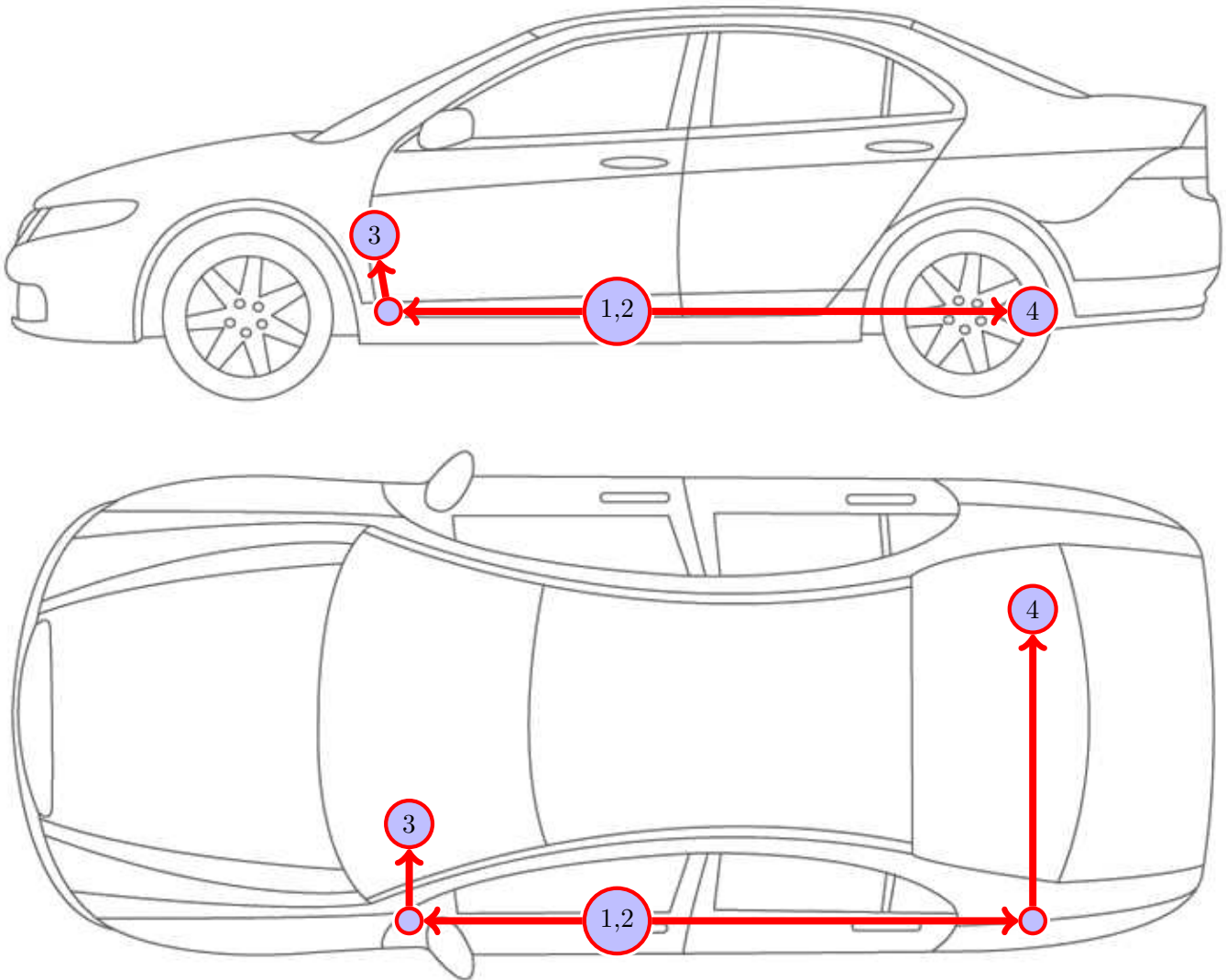

Figure 3: Vehicle overview

- 1 Connection CAN High / CAN Low
- 2 Control units
- 3 Pushbutton
- 4 External sound generator

10 Removing trim panel of the dashboard

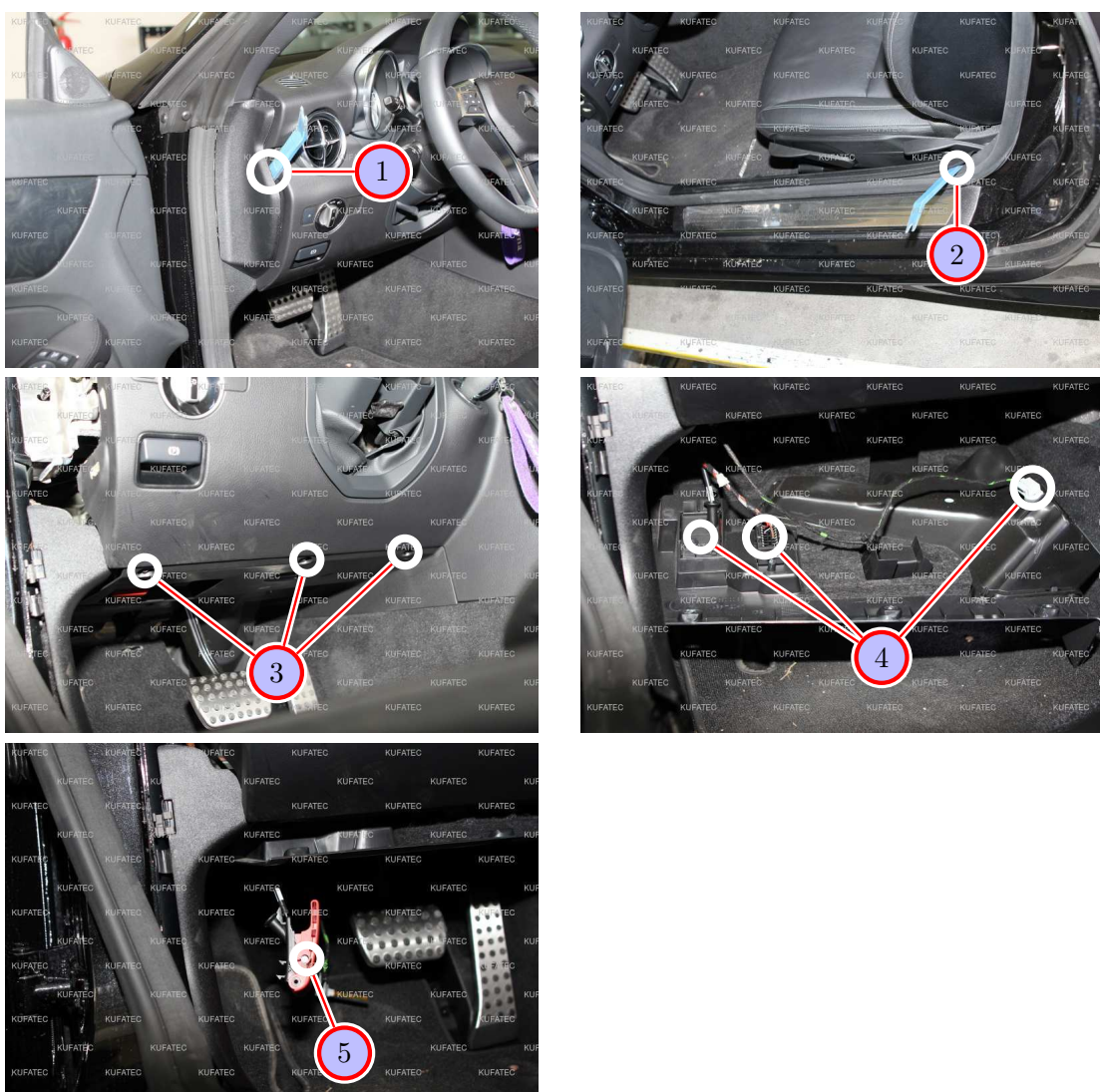

Figure 4: Removing trim panel of the dashboard

Table 2: Removing trim panel of the dashboard - instructions

Nr.	Work step	Note
1	Remove the lateral trim panel of the dashboard using a trim tool.	
2	Loosen and remove the sill trim using a trim tool.	
3	Loosen the marked screws of the lower trim panel of the dashboard.	T20
4	Remove the plug connections and push the hood release down afterwards.	
5	Now remove the Bowden cable out of the hood release. Afterwards the lower trim panel of the dashboard can be taken out completely.	

11 Removing driver's seat

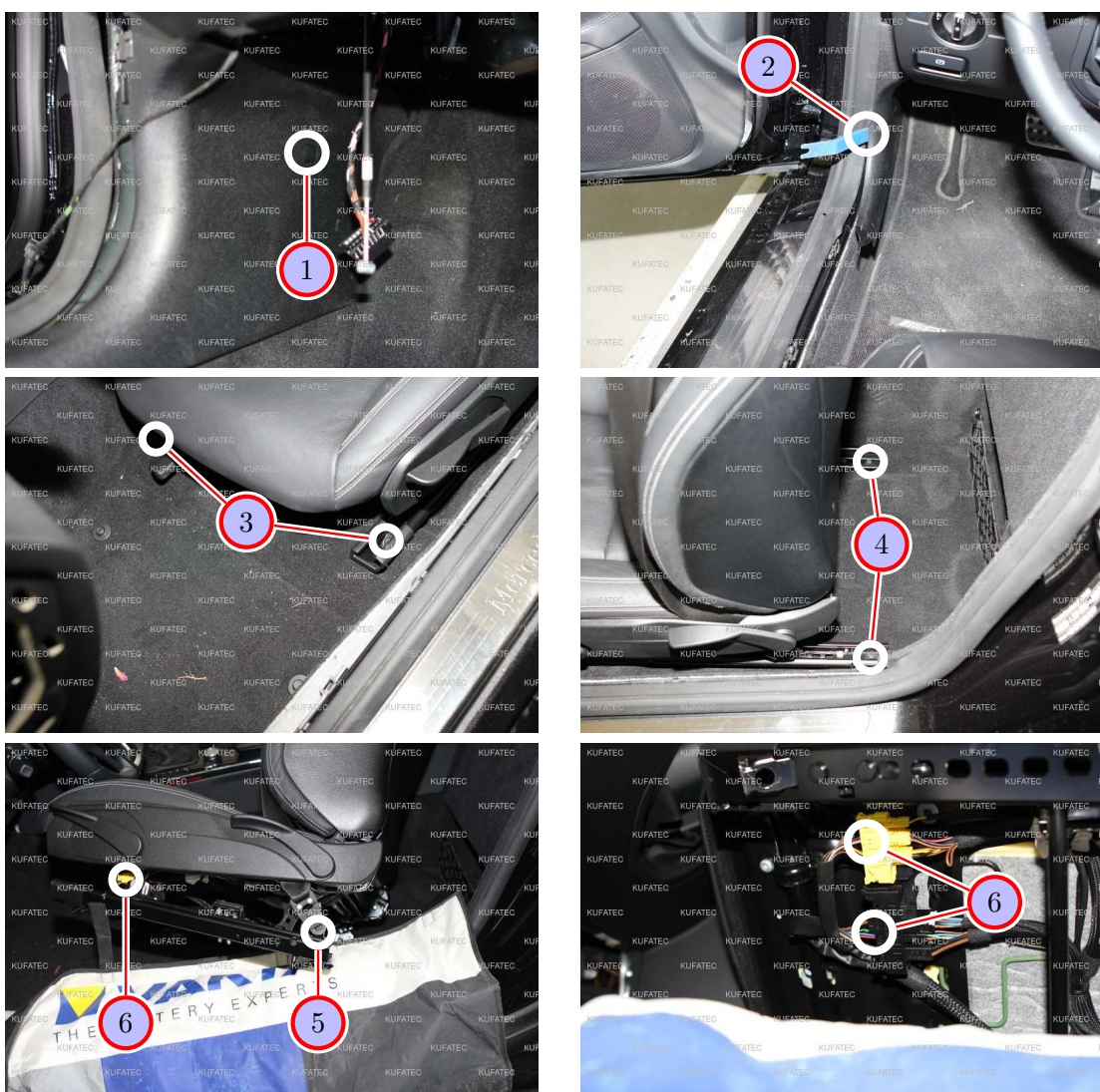

Figure 5: Removing driver's seat

Table 3: Removing driver's seat - instructions

Nr.	Work step	Note
1	Remove the screw cap and loosen the screw, which is located behind, afterwards.	1xT20
2	Now loosen the lower trim panel of the a-pillar using a trim tool.	
3	Loosen the front screws of the driver's seat.	2xE14
4	Push the seat quite forward and loosen the rear screws of the driver's seat.	2xE14
5	Loosen the seat belt out of the interlock and guide it up out.	
6	Lay the seat on its side carefully and loosen the marked plugs afterwards. Now take the entire driver's seat out.	

12 Connection cable set

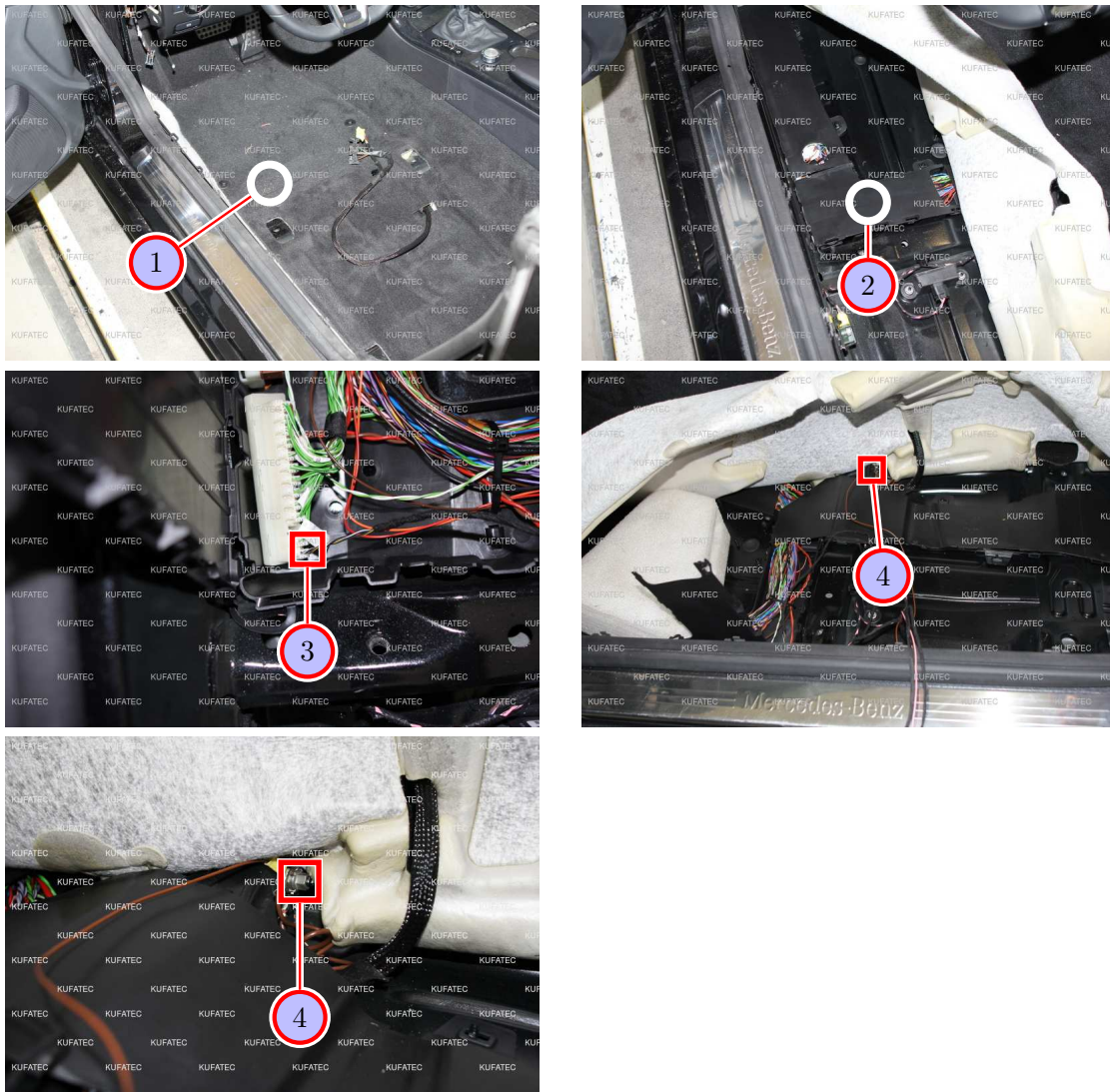

Figure 6: Connection cable set

Table 4: Connection cable set - instructions

Nr.	Work step	Note
1	Fold the carpet in the direction of the center console.	
2	Open the marked cable channel and uncover the CAN distributor.	
3	Now connect the connecting cable for CAN High and Low also to the marked CAN distributor and pay attention to the following: CAN High (black/white) has to lay on green/white, CAN Low (black/yellow) has to lay on green.	
	If the connecting cables are exclusively grey, please pay attention to the cable inscription at the end of the individual wires.	
4	Route the ground cable (brown) along the cable channel and connect it also to the marked ground spot.	

13 Removing center console

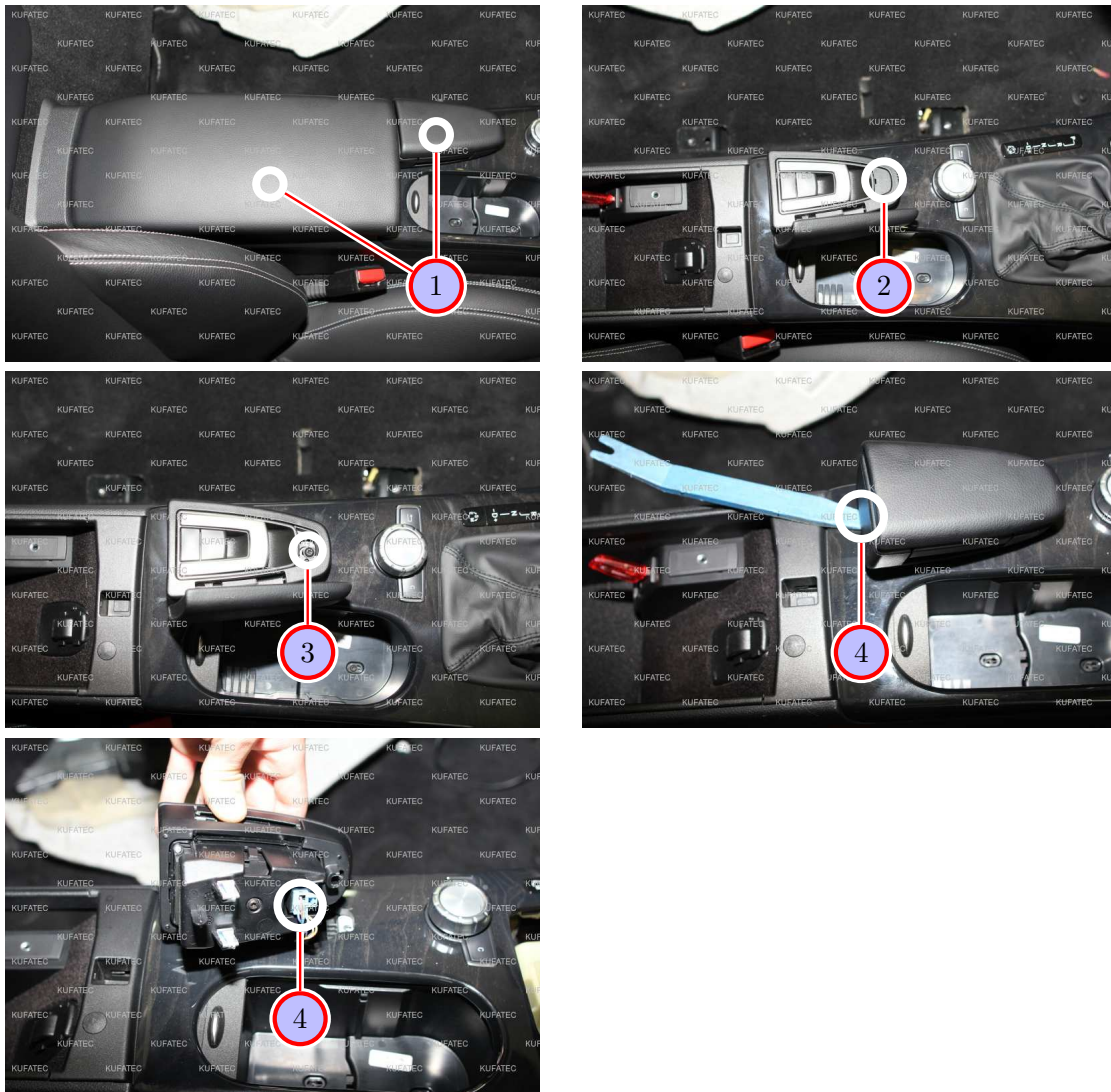

Figure 7: Removing center console

Table 5: Removing center console - instructions

Nr.	Work step	Note
1	Open the big oddments tray as well as the covering for the folding top controls.	
2	Remove the marked covering in the front at the folding top controls.	
3	Now loosen the marked screw.	1xT20
4	Now loosen the folding top controls with a trim tool.	
5	Remove the marked plug of the folding top controls and take them out completely.	

14 Removing center console

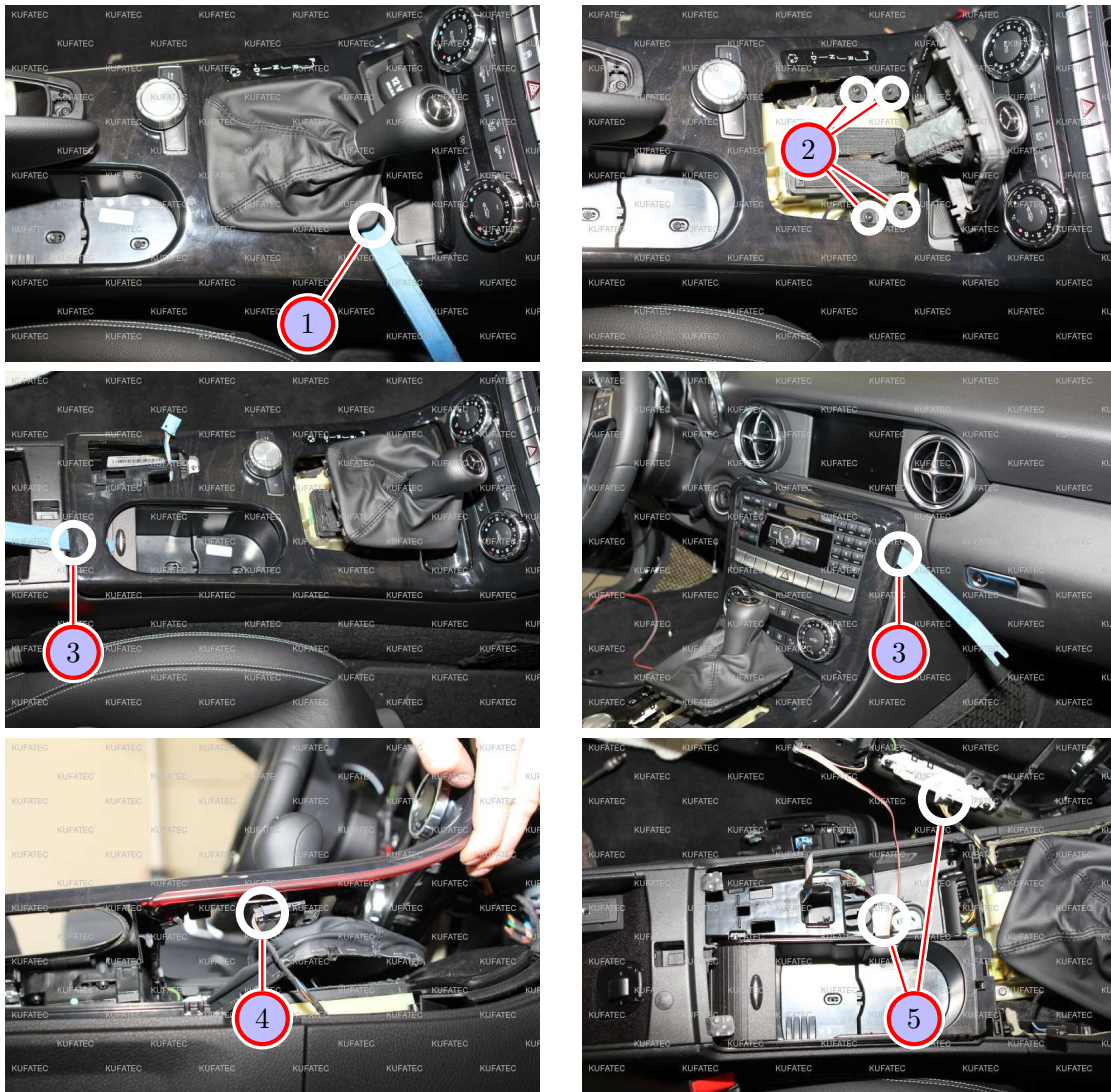

Figure 8: Removing center console

Table 6: Removing center console - instructions

Nr.	Work step	Note
1	Loosen the leather covering of the gearshift lever using a trim tool.	
2	Loosen the marked screws of the trim panel of the center console.	4xT20
3	Now loosen the trim panel of the center console at the marked spots with a trim tool and pull the trim panel up carefully.	
4	Remove the marked plug at the trim panel.	
5	Pull the trim panel further up and remove the other marked plugs.	

15 Connection ignition lead

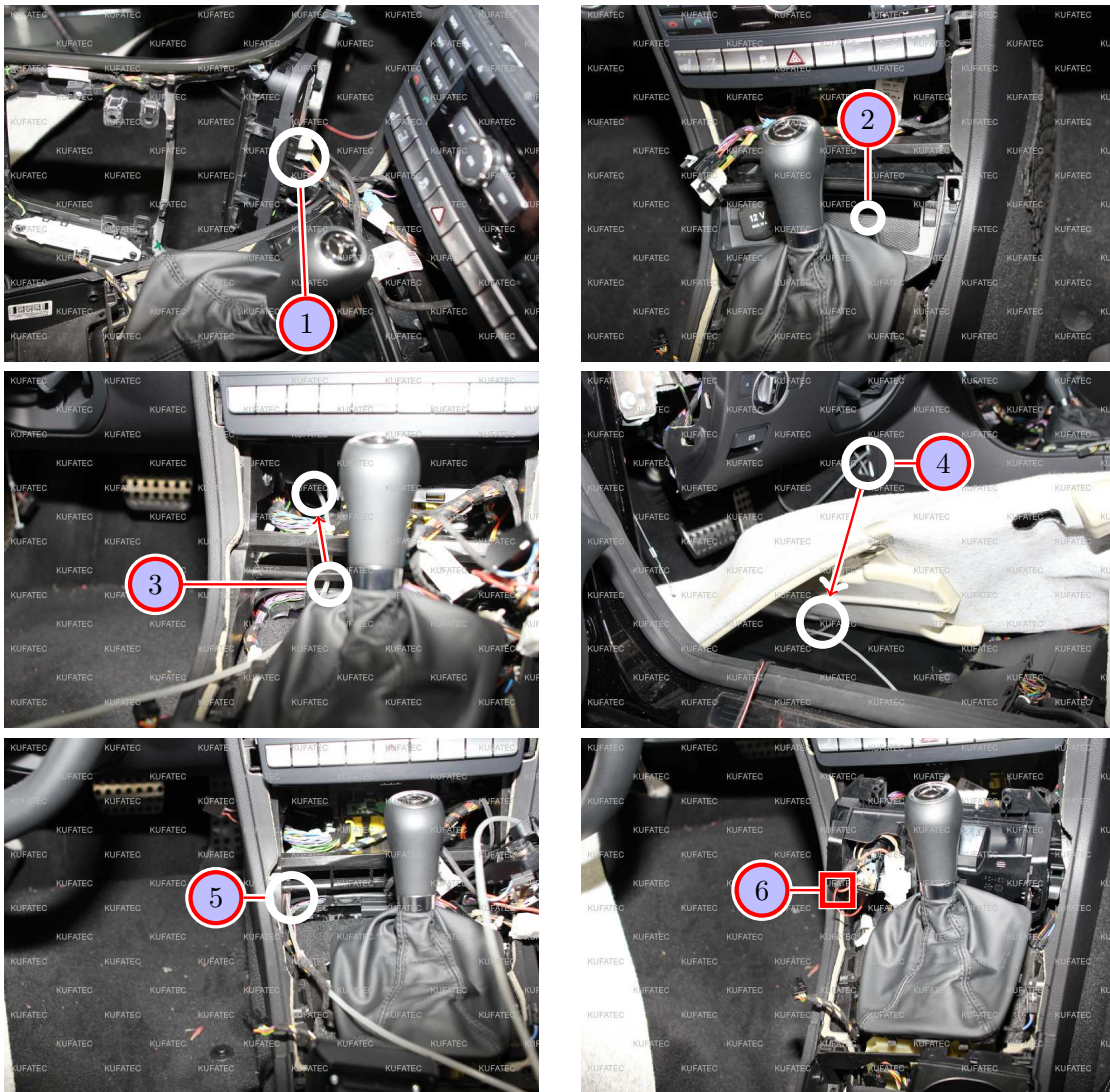

Figure 9: Connection ignition lead

Table 7: Connection ignition lead - instructions

Nr.	Work step	Note
1	Remove now the rest of the plugs from the trim panel of the center console and take it out completely afterwards.	
2	Pull the ashtray including the cigarette lighter out carefully.	
3	Guide now a pull through aid through the center console in the direction of the footwell.	
4	Pull the pull through aid further through and afterwards guide it beneath the carpet to the cable channel. Now attach the connecting cable for ignition lead to the pull through aid.	
5	Pull now the pull through aid together with the connecting cable back to the center console.	
6	Now connect the cable for ignition lead (red/white) also to the red cable of the cigarette lighter.	

16 Installation pushbutton / routing connecting cable sound generator

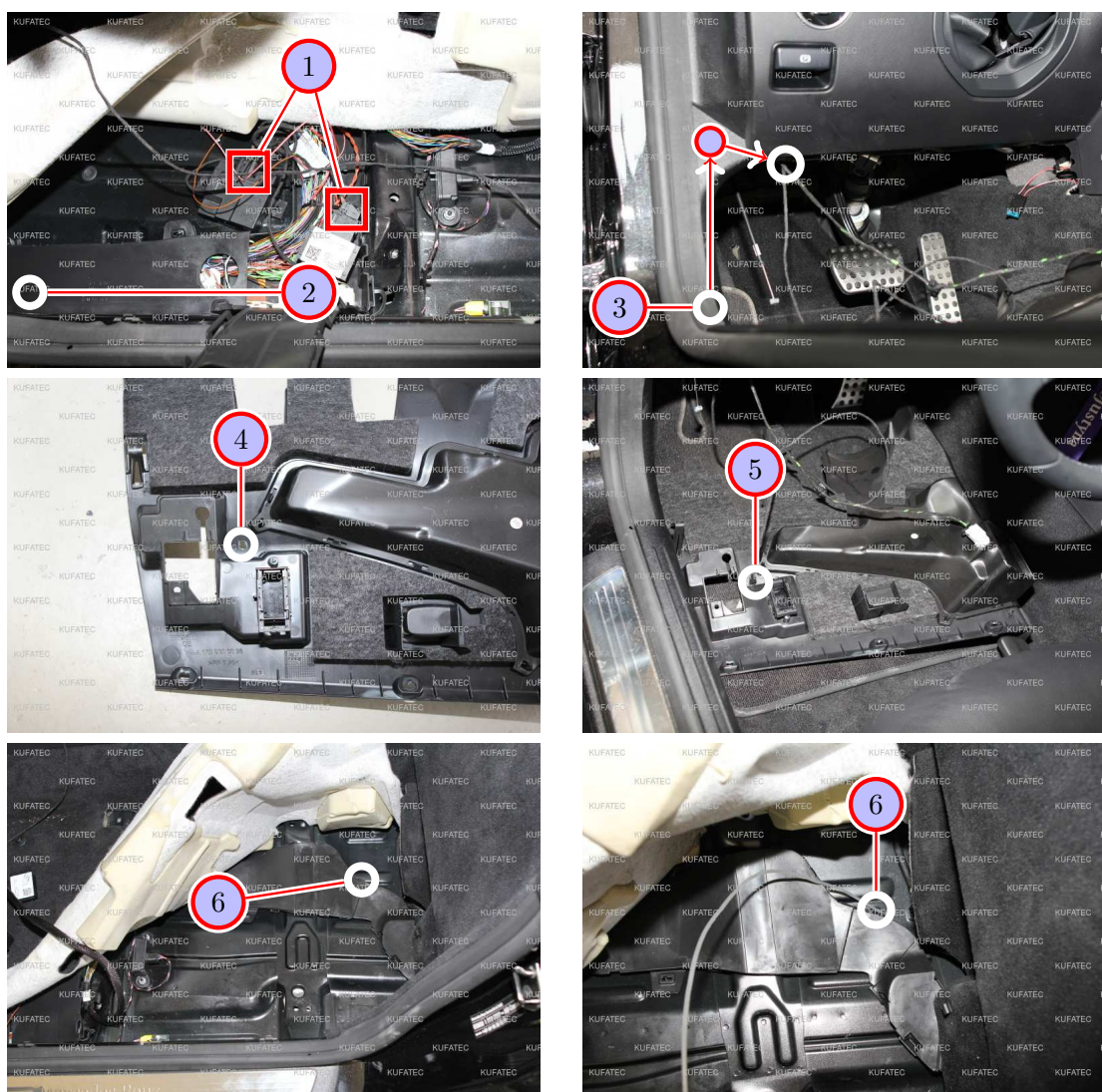

Figure 10: Installation pushbutton / routing connecting cable sound generator

Table 8: Installation pushbutton / routing connecting cable sound generator - instructions

Nr.	Work step	Note
1	Connect the control unit as well as the module to the cable set and place it at the marked positions. Cut a suitable opening in the foam, so that the carpet rest on straightly again afterwards.	
2	Route the cable for the pushbutton along the cable channel to the dashboard.	
3	Pull the cable for the pushbutton at the a-pillar up in the dashboard.	
4	Drill a hole for the pushbutton at the marked position.	7mm
5	Afterwards install the pushbutton at the lower trim panel of the dashboard.	
6	Now guide the connecting cable for the sound generator through the marked grommet to the underbody.	

17 Routing connecting cable sound generator

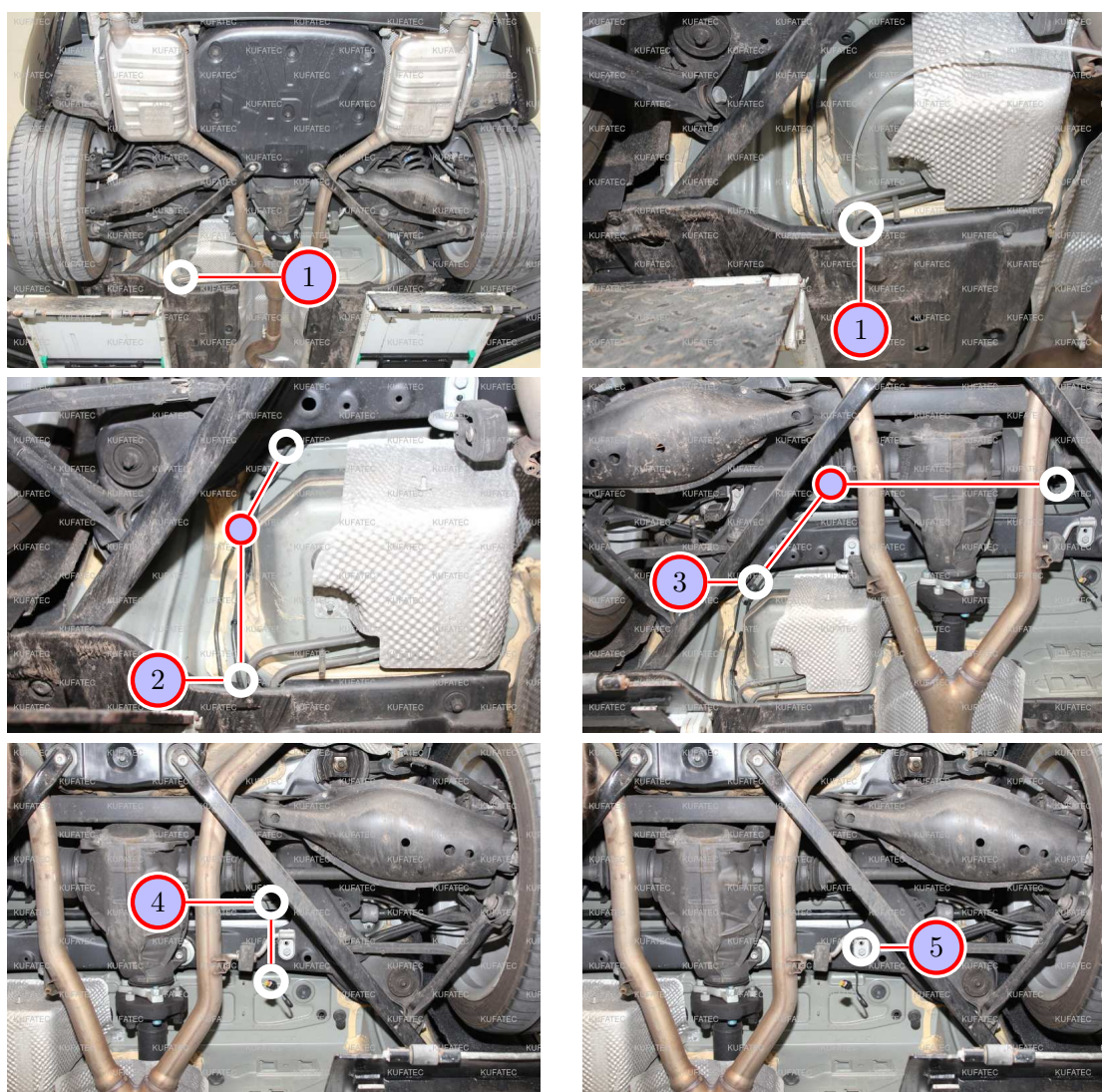

Figure 11: Routing connecting cable sound generator

Table 9: Routing connecting cable sound generator - instructions

Nr.	Work step	Note
1	Pull the connecting cable out from under the trim panel of the underbody.	
2	Route the connecting cable along the brake pipes up to the axle. Attach the connecting cable to the brake pipes carefully with cable ties.	
3	Route the connecting cable behind the axle along the brake pipe to the right side and fix it with suitable cable ties.	
4	Pull the connecting cable in front of the axle out and attach the cable with cable ties to the brake pipes here too.	
5	Loosen the marked screw of the exhaust bracket.	13er socket

18 Installation sound generator

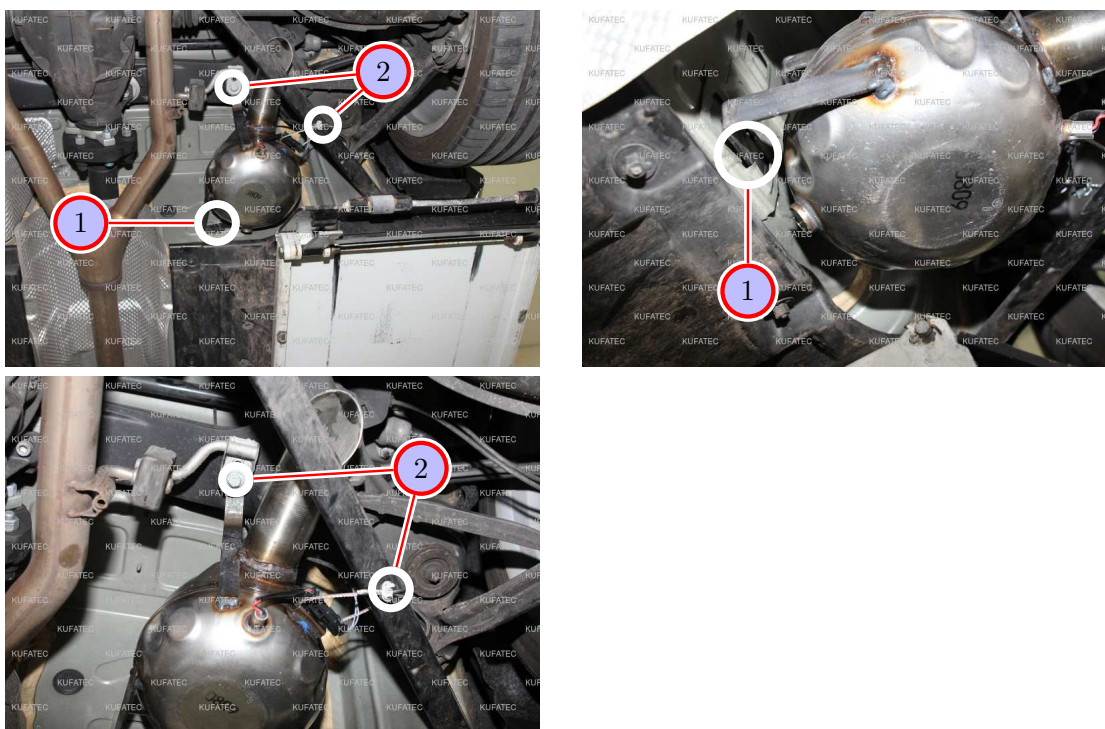

Figure 12: Installation sound generator

Table 10: Installation sound generator - instructions

Nr.	Work step	Note
1	Push the sound generator in the marked bracket at the vehicle.	
2	Now attach the sound generator with the screw of the loosened exhaust bracket and additionally fix the delivered safety rope to the sound generator as well as to the vehicle.	

19 Important Information Sound Booster

Please use for the fixation of the Sound Booster suitable high tensile screws. In order to avoid loosening of the screws by vibration please make the screws safe with appropriate factory material e.g Threadlock. Please additionally check the stability of the Sound Booster regularly and if necessary retighten the screws. In case of no consideration we do not assume liability for possible damages. After successful installation we recommend to cover the sound generator with a zinc spray. Make sure that you cover the opening of the sound generator so that no zinc spray can't get inside the sound generator.

As additional safety the delivered steel cable and the retaining clips have to be tightened on the Sound Booster as well as at a suitable position in the car. This safety cable is an additional security should the tightening screws should be released by vibration.

List of Figures

1	How to connect a cable to another	6
2	Cable Inscription	7
3	Vehicle overview	8
4	Removing trim panel of the dashboard	9
5	Removing driver's seat	10
6	Connection cable set	11
7	Removing center console	12
8	Removing center console	13
9	Connection ignition lead	14
10	Installation pushbutton / routing connecting cable sound generator	15
11	Routing connecting cable sound generator	16
12	Installation sound generator	17

List of Tables

1	How to connect a cable to another	6
2	Removing trim panel of the dashboard - instructions	9
3	Removing driver's seat - instructions	10
4	Connection cable set - instructions	11
5	Removing center console - instructions	12
6	Removing center console - instructions	13
7	Connection ignition lead - instructions	14
8	Installation pushbutton / routing connecting cable sound generator - instructions	15
9	Routing connecting cable sound generator - instructions	16
10	Installation sound generator - instructions	17