



Installation Instructions

Complete set active Sound incl. Soundbooster

Mercedes CLS W219

v1.2 (16.06.2017)

Contents

1	Liability Exclusion	3
2	Copy Right	4
3	General Notes	4
4	Safety instructions	5
5	Requirements for the determinable operation	5
6	Note	5
7	How to connect a cable to another	6
8	Note Cable Inscription/Color	7
9	Assembly Instructions	8
10	Removing trim panel driver's side / connection CAN High & Low	9
11	Removing trim panel center console	10
12	Connection ignition lead / ground	11
13	Installation pushbutton / placing control unit & module	12
14	Removing front trim panel passenger's side	13
15	Removing rear trim panel passenger's side	14
16	Cable routing to the trunk	15
17	Removing trim panel trunk	16
18	Cable routing to the underbody	17
19	Removing rear interior trim of the wheel housing passenger's side	18
20	Installation sound generator	19
21	Important Information Sound Booster	20

1 Liability Exclusion

Dear Customer

Our cable sets are developed according to the connection- and circuit diagrams of the corresponding car manufacturer. Before the original production the cable sets will be tested on an original car. Therefore, the integration into the car electronics will be executed according to the instructions of the manufacturer. Regarding the necessary pre-understanding and the accuracy of the presentation of texts and pictures our mounting guidelines correspond to the usual ones in car technology and car electronics. Practically, they have been proved one's worth a hundred times.

However, should there be any difficulties during the installation of our products we will be at your disposal any time for support by phone or by mail. Moreover, we offer you to execute the installation at our works in Bad Segeberg.

Costs which may arise because a third person will execute the installation of our products will not be supported by us in any case. Only if there is a mistake caused by our product we will pay the proved costs of the installation as well as the costs of the removal of the defective product. The refund of expenses will be limited to gross EUR 110,- ; we reserve the right to check the described mistake in our works in Bad Segeberg. In case of a proved reclamation the costs for dispatch for the check in our factory will be transferred to you.

According to our experience each specific factory which has the necessary diagnostic device, diagnostic software and the circuit diagrams of the manufacturer can find possible mistakes at our products within a short time. So the installation and removal including diagnostic inspection can be realised in at most 60 minutes.

We also made the experience that many specific factories cannot work with the circuit diagrams of the manufacturer, and that they cannot read usual wiring diagrams. Therefore, very easy installation works will take many hours. You will understand that we neither take the risk to find a reliable specific factory nor the financing of the training of the staff of your favoured factory.

Costs which will arise because you buy missing parts or spare parts at other suppliers will be refunded by us up to the amount of the costs which had been arisen by additional supply (saved expenses). In this case, there would be no right for refund according to the legal guarantee right as long as we have no deadline for supplementary performance or a deadline for supplementary performance has not expired.

So if you have any problems with the installation or operation of one of our products please call us, send us an email, send us the product or take your car to our factory in Bad Segeberg. We are sure to find an appropriate solution for each concern.

With best regards
Your Kufatec GmbH & Co. KG Team

2 Copy Right

Our installation- and removal instructions, installation plans, software and other documentation with texts or pictures are protected by copy right.

A publication or distribution of these documents is only permitted with a written approval of Kufatec GmbH & Co. KG.

3 General Notes

Regarding the development there has especially been paid attention to your personal safety together with the most possible operating comfort, modern design and actual product technologies.

Despite most possible accuracy in case of incorrect installation or use or in case of incorrect operating, it is possible that injuries or damages of property may arise.

Therefore, please read the operating instructions you have received carefully and completely, and keep it with you.

All articles of our production will be checked at 100% — for your safety.

We reserve the right to make technical changes which serve the progress at any time.

Before the installation or startup it may be necessary, depending on the article and purpose of use, to check the legal instructions of each country.

In case of warranty claim the device has to be sent to the seller originally packed together with the sales receipt and a detailed description of the mistake. Please consider the manufacturer's instructions for return (RMA). The legal warranty instructions are valid.

The warranty claim and also the permission for startup will expire in case of:

- unauthorised changes on the device or the accessories which have not been executed or approved by the manufacturer or its partners
- opening of the box
- repair of the device on your own
- incorrect use / no normal use / startup
- influence of force on the device (falling down, wilful damage, accident, etc.)

During the installation please consider all safety and legal instructions. The device may only be installed by trained qualified personnel or persons who are similar qualified.

In case of installation- or function problems please reduce the search of the mistake to approx. 0,5 hours for mechanical works or 1,0 hours for electronic works.

To avoid unnecessary additional work and expenses, please send immediately an inquiry to our technical support with the Kufatec contact form (<http://www.kufatec.de/shop/de/infocenter/>)

Please absolutely mention the following:

- car chassis number
- part number of the add-on kit
- exact description of the problem
- work steps already made

4 Safety instructions

The installation may only be executed by trained qualified personnel. Please execute the installations only in a condition of dead voltage. Here please separate for example the battery from the main power supply and consider the instructions of the car manufacturer.

- In order to not endanger your own driving safety please never use security relevant screws, bolts or other fixation pieces at steering, brake system or other components.
- Connect the device only at 12V wiring system voltage with ground connection to the autobody. This assembly is not allowed for the use in trucks or other cars with 24V wiring system voltage.
- Please avoid the installation of the device at positions where the driving safety or the functional efficiency of other subassembly integrated in the car are restricted.
- This module may only be used together with the following mentioned car types and models; the installation may be executed exclusively by use of the circuit points mentioned in the assembly instructions.
- Kufatec GmbH & Co. KG does not assume liability for damages which are caused by incorrect installation, the use of inapplicable circuit points or the installation into car types and -modules which are not foreseen.
- We would like to draw your attention to the fact that the module processes the data of the MOST-protocol of the car mentioned below. Therefore, during the installation of the module it will be used a model-specific complete system which we as the manufacturer of the mentioned construction line only know partly.
- Especially in case of changes within the same model line and the same year we therefore cannot guarantee the applicability of our construction line in each case. Kufatec GmbH & Co. KG does not assume liability for the applicability of our construction line with changes made by the manufacturer.
- Kufatec GmbH & Co. KG does not assume liability that the installation of the here described component has been permitted according to the guarantee instructions of particular car manufacturers. Therefore, please consider the guidelines for installation and guarantee conditions of your car manufacturer before installation.
- The manufacturer reserves the right to change components without giving reasons.
- Subject to errors and changes

5 Requirements for the determinable operation

Please use the device only in its the corresponding area.

In case of unprofessional and untypical use, installation or modification the permission for operation and the warranty claim will expire.

6 Note

Make sure that there's enough space at the described position. If there is no space please cancel the installation and contact our technical support.

The use of a sound booster is not permitted without registration in the vehicle papers, in the area of the german StVZO. The noise emission of the vehicle is increased by this retrofit. The regulations of the StVZO must be observed. It is therefore recommended to ask for a specific registration option at the responsible TÜV/DEKRA office before retrofitting. Outside Germany, please observe the laws on vehicle licensing applicable in your country.

7 How to connect a cable to another

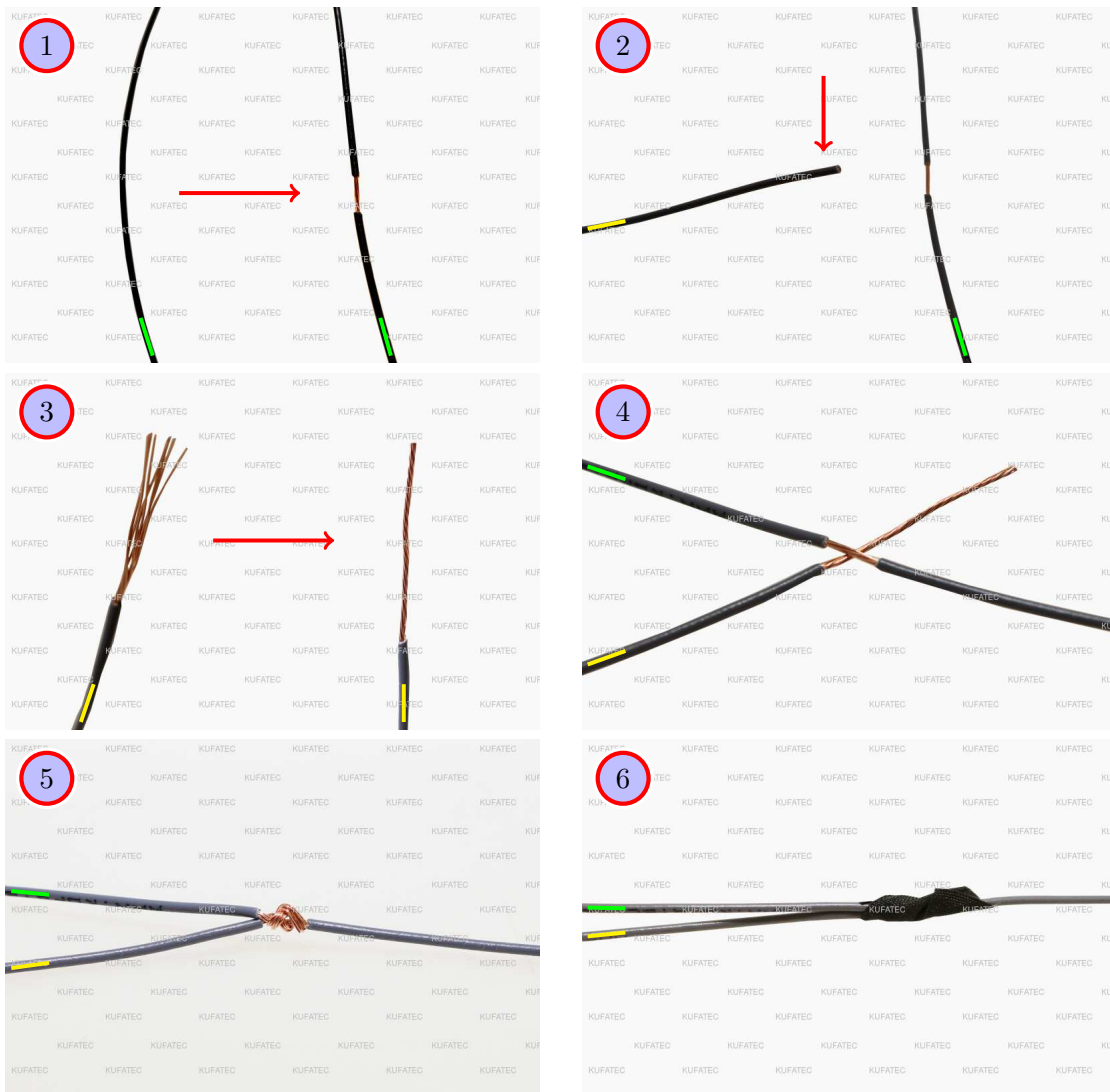

Figure 1: How to connect a cable to another

Table 1: How to connect a cable to another

No.	Work step	Note
1	Take the cable of the vehicle, to which you want to connect, (green marked here) and strip the insulation at one point with a suitable tool (cable stripper/cutter knife).	
2	Now take the cable of the cable set, which you want to connect, (yellow marked here) and strip the insulation at the end.	
3	Twirl the wires of the stripped cable together.	
4	Place the end of the cable you want to connect under the stripped point of the cable of the vehicle...	
5	... and wrap the cable you want to connect around the cable of the vehicle.	
6	Lastly, stick insulating tape around the connection point.	

8 Note Cable Inscription/Color



Figure 2: Cable Inscription

If our cable set consists exclusively of grey wires, connect the wires according to the cable inscription.

9 Assembly Instructions

The following illustration shows the cable routing as well as the position of the individual components.

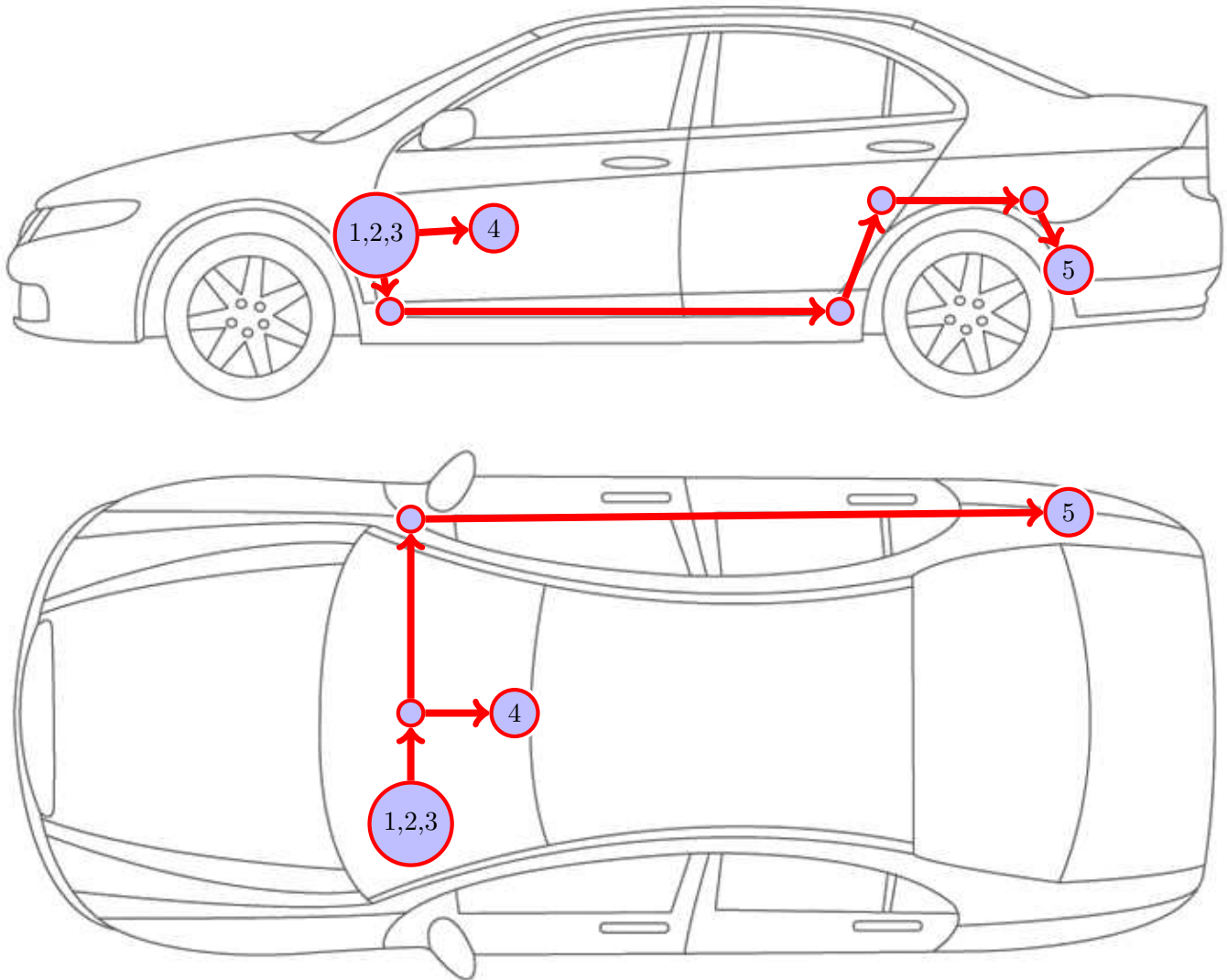

Figure 3: Vehicle overview

- 1 Connection CAN High / CAN Low
- 2 Control units
- 3 Pushbutton
- 4 Connection ignition lead
- 5 External sound generator

10 Removing trim panel driver's side / connection CAN High & Low

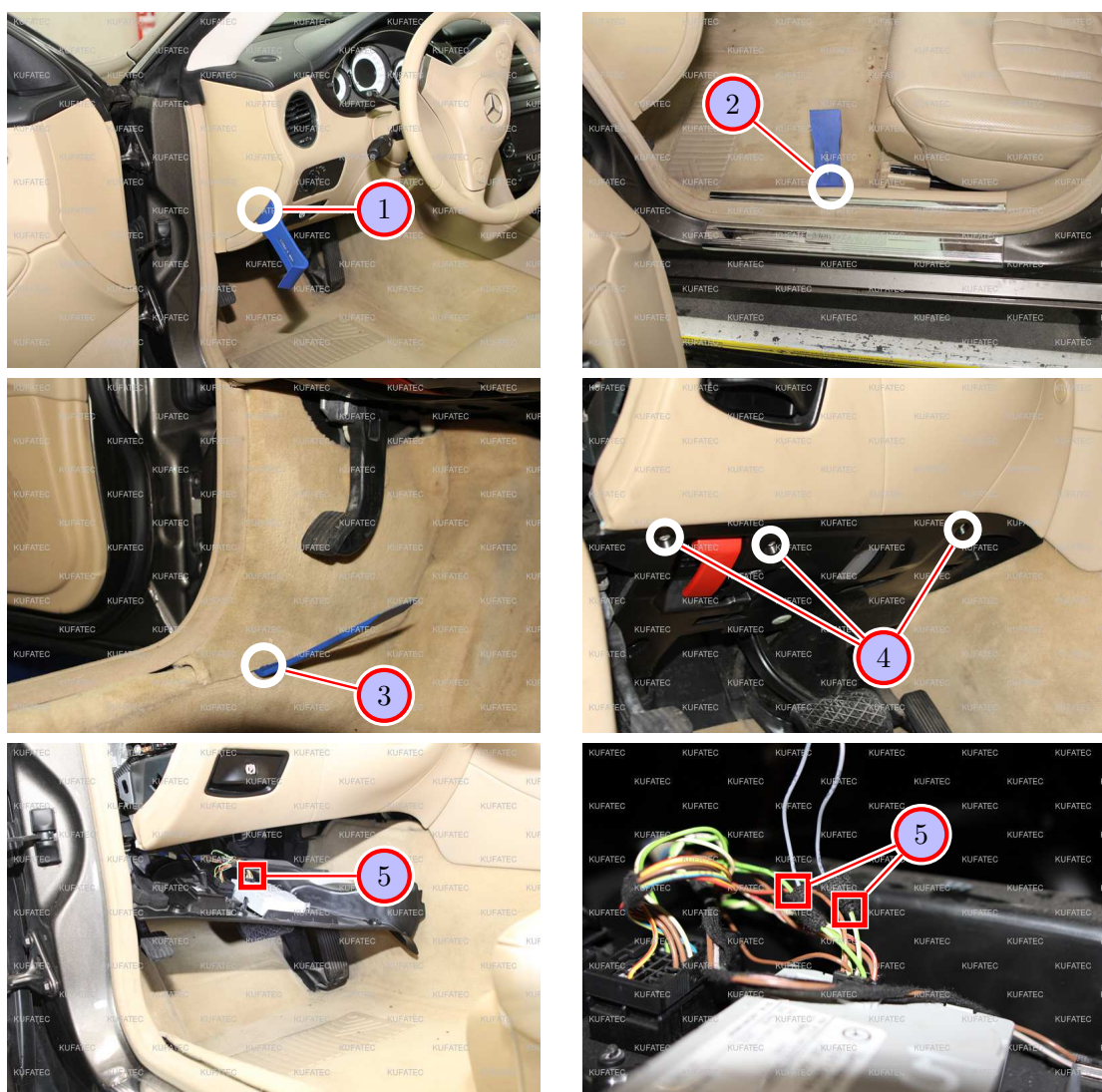

Figure 4: Removing trim panel driver's side / connection CAN High & Low

Table 2: Removing trim panel driver's side / connection CAN High & Low - instructions

Nr.	Work step	Note
1	Remove the lateral covering of the dashboard using a trim tool.	
2	Loosen and remove the sill trim using a trim tool.	
3	Loosen the trim panel of the a-pillar with a trim tool.	
4	Loosen the marked screws of the lower trim panel of the dashboard.	3xT25
5	Connect CAN High & Low to the plug of the central gateway as follows:	
	CAN High (black/white) to pin 8 (green/white)	
	CAN Low (black/yellow) to pin 7 (green)	
	If our cable set consists exclusively of grey wires, connect the wires according to the cable inscription at the end of the wires.	

11 Removing trim panel center console

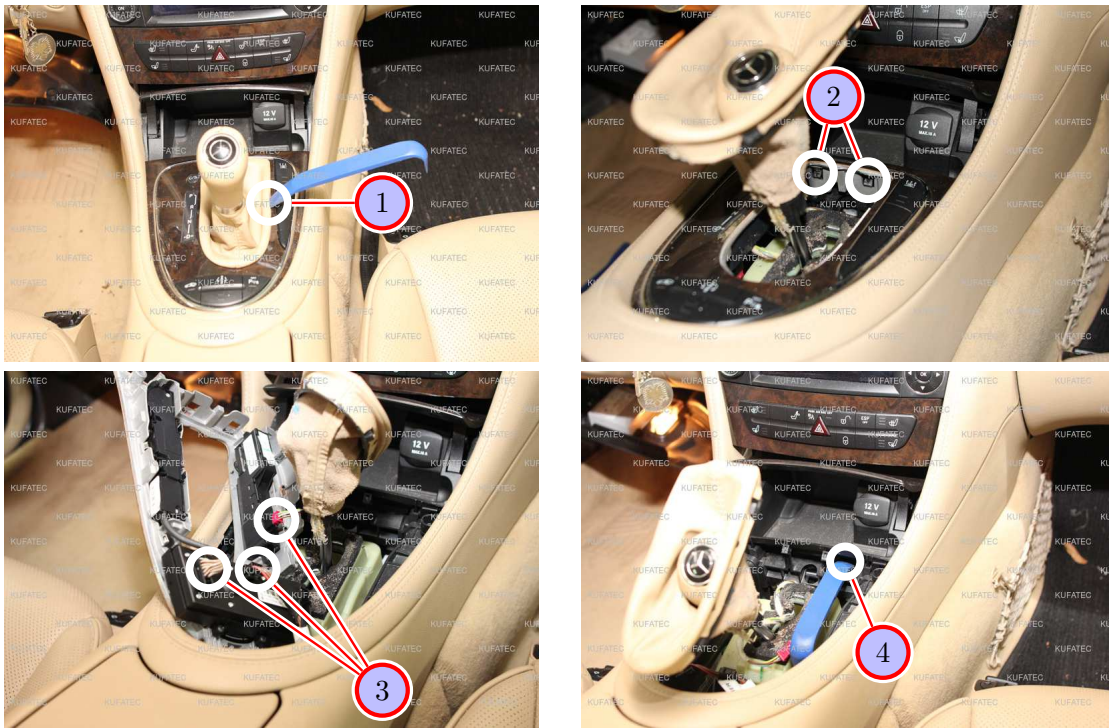

Figure 5: Removing trim panel center console

Table 3: Removing trim panel center console - instructions

Nr.	Work step	Note
1	Loosen the gearshift bag using a trim tool and pull it up.	
2	Loosen the marked snap fits and pull the trim panel up carefully.	
3	Remove the marked plugs and take the trim panel out completely afterwards.	
4	Loosen the oddments tray including the 12V power outlet and pull it out from behind carefully.	

12 Connection ignition lead / ground

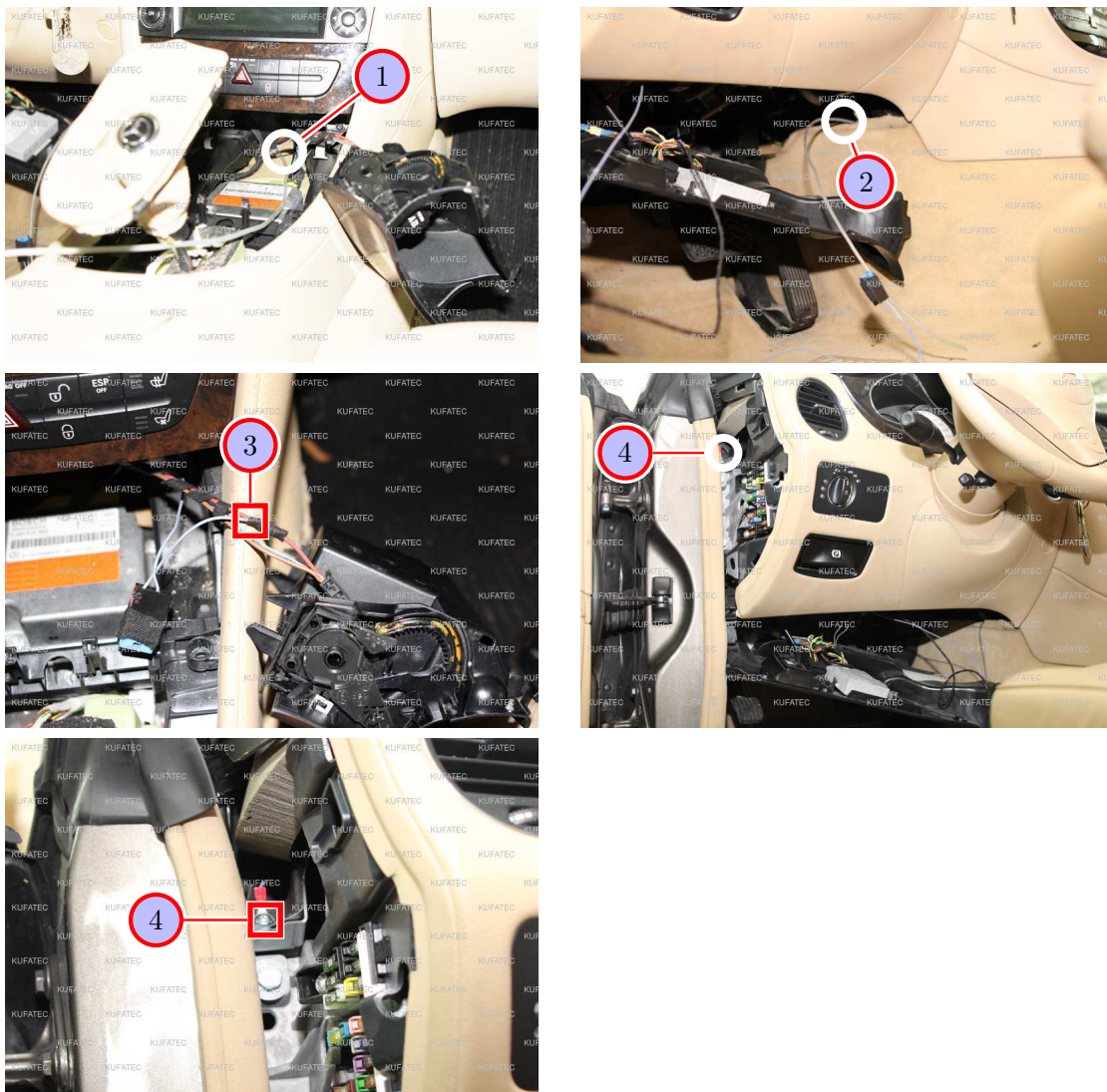

Figure 6: Connection ignition lead / ground

Table 4: Connection ignition lead / ground - instructions

Nr.	Work step	Note
1	Guide a pull through aid through the center console in the driver's footwell.	
2	Attach the connecting cable for ignition lead (red/white) to the pull through aid and pull it back to the center console.	
3	Connect the cable for ignition lead (red/white) also to the red/blue cable of the cigarette lighter.	
4	Pull the ground cable (brown) up to the marked ground spot and connect it also there.	1xT25

13 Installation pushbutton / placing control unit & module

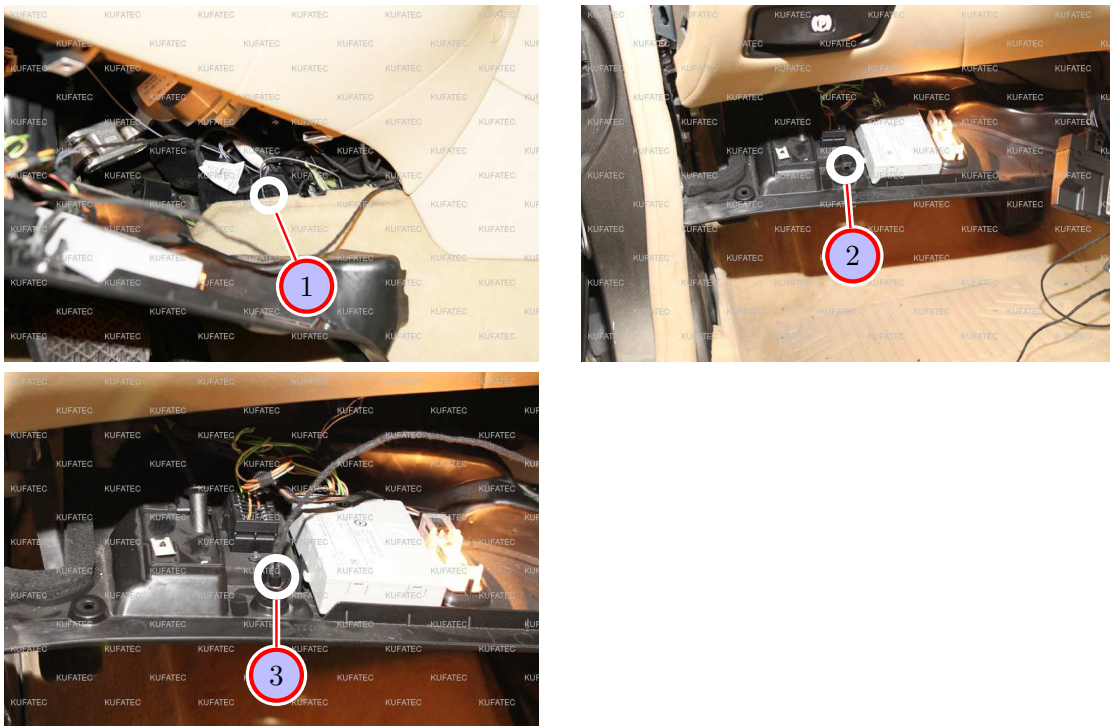

Figure 7: Installation pushbutton / placing control unit & module

Table 5: Installation pushbutton / placing control unit & module - instructions

Nr.	Work step	Note
1	Connect the control unit and the module and place it at the marked position in the center console.	
2	Drill a hole for the pushbutton at the marked position.	7mm
3	Now install the pushbutton at this position.	

14 Removing front trim panel passenger's side

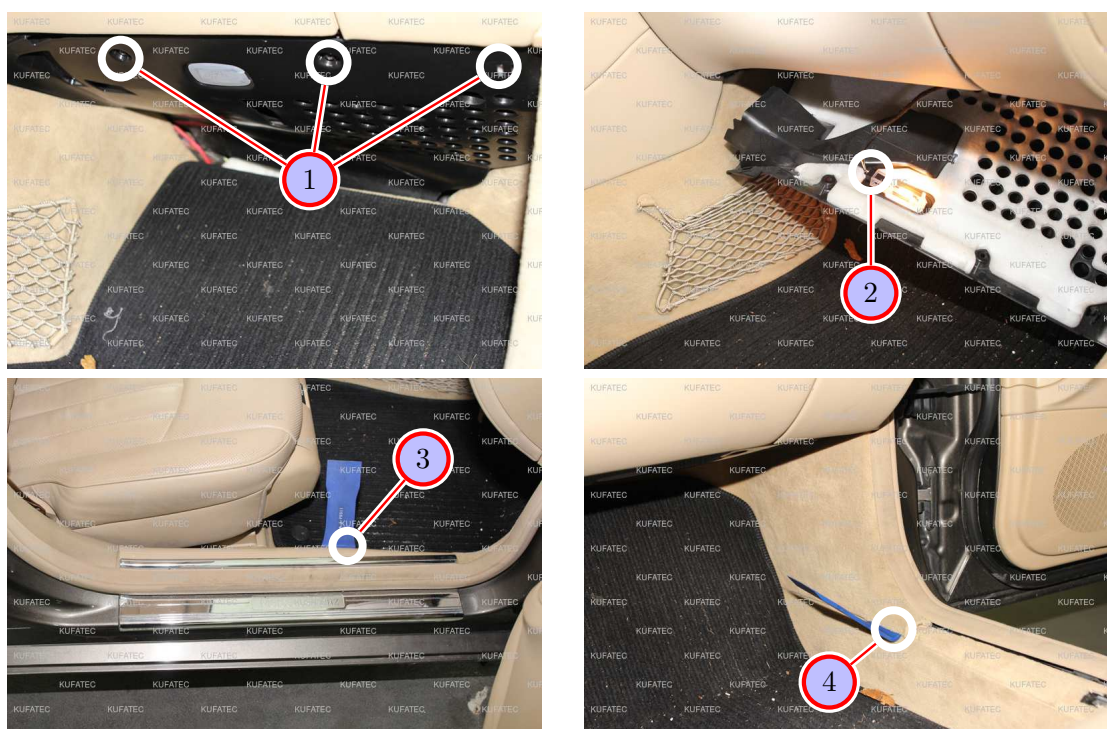

Figure 8: Removing front trim panel passenger's side

Table 6: Removing front trim panel passenger's side - instructions

Nr.	Work step	Note
1	Loosen the marked screws of the lower trim panel of the glove compartment and pull it down carefully.	3xT25
2	Loosen the marked plug and take the trim panel out completely.	
3	Remove the sill trim using a trim tool.	
4	Loosen and remove the trim panel of the a-pillar using a trim tool.	

15 Removing rear trim panel passenger's side

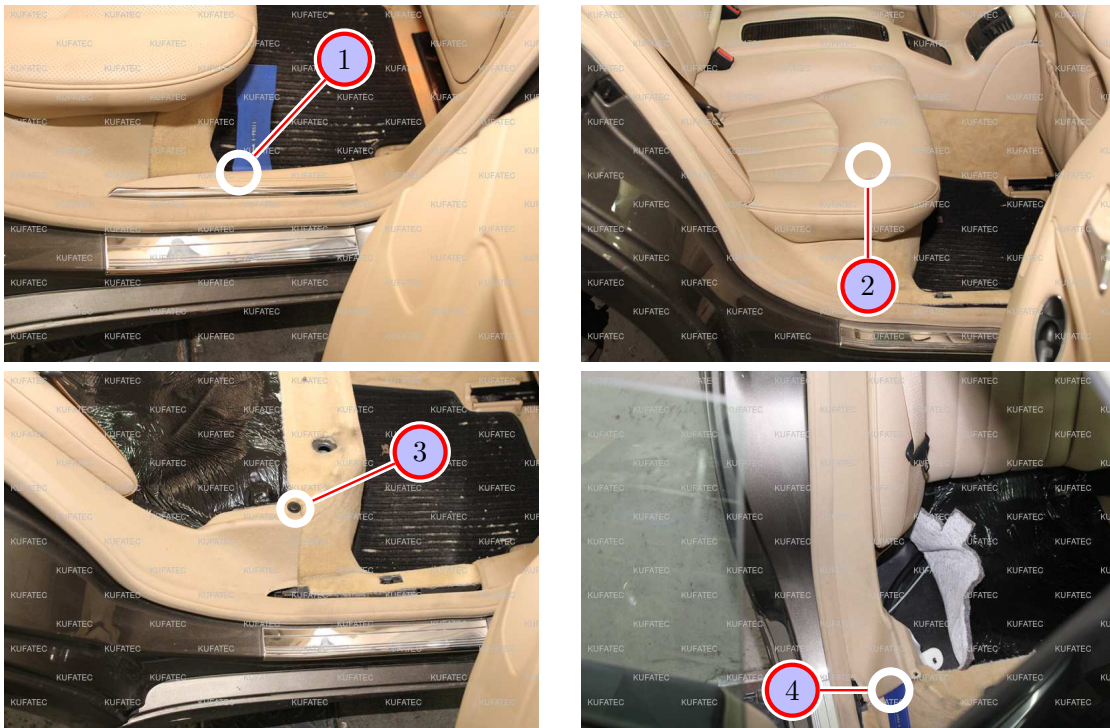

Figure 9: Removing rear trim panel passenger's side

Table 7: Removing rear trim panel passenger's side - instructions

Nr.	Work step	Note
1	Loosen the rear sill trim using a trim tool.	
2	Remove the marked seat by pulling it up in the front.	
3	Remove the marked plastic clip.	
4	Loosen the rear lateral trim panel using a trim tool. Afterwards it can be taken out.	

16 Cable routing to the trunk

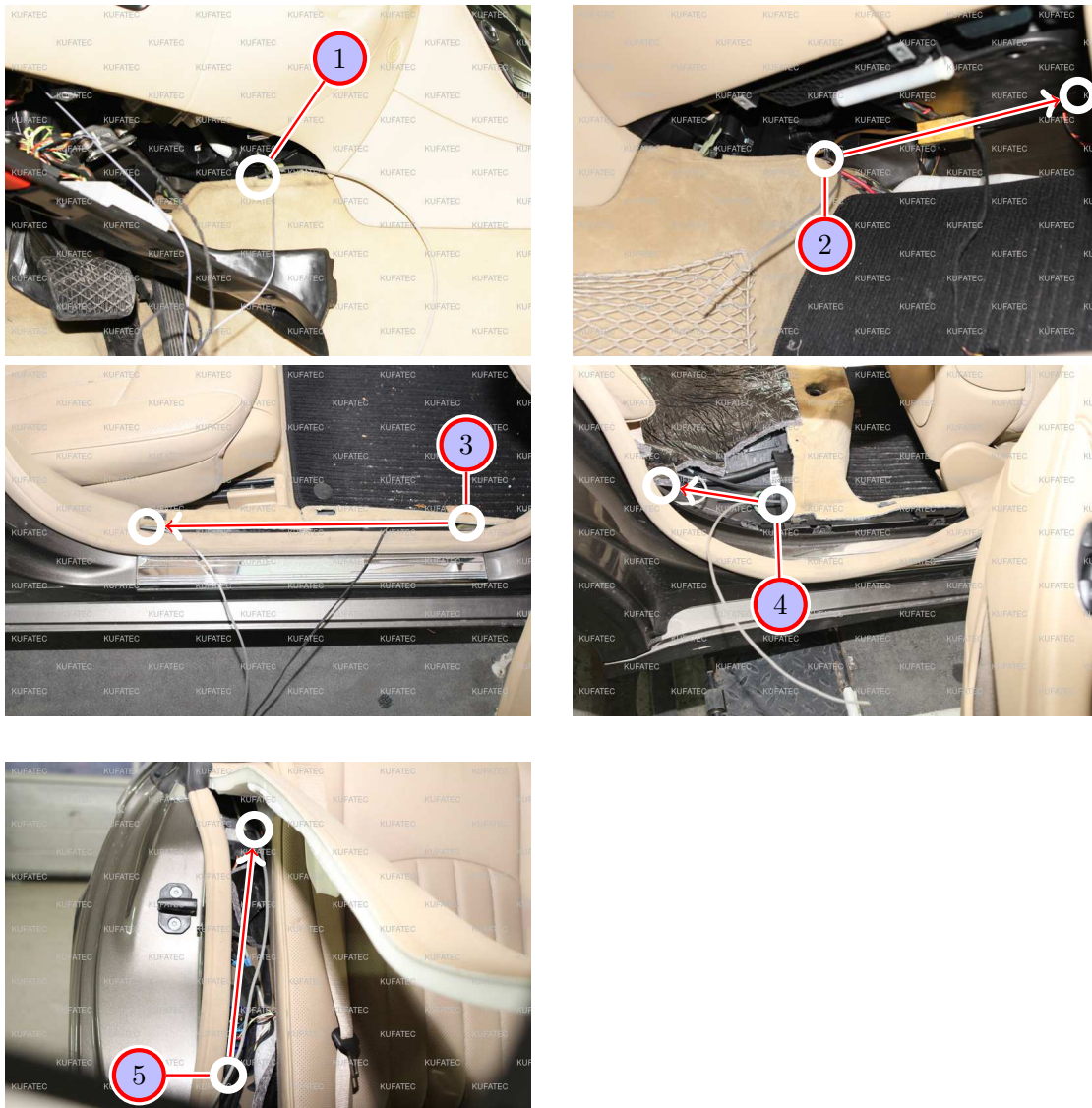

Figure 10: Cable routing to the trunk

Table 8: Cable routing to the trunk - instructions

Nr.	Work step	Note
1	Guide the connecting cable for the sound generator behind the center console to the passenger's side using a pull through aid.	
2	Pull the connecting cable further through and route it to the a-pillar on the passenger's side.	
3	Route the connecting cable along the sill trim to the b-pillar.	
4	Pull the connecting cable out from behind the trim panel of the b-pillar and route it up along the marking.	
5	Guide the connecting cable over the wheel housing in the trunk.	

17 Removing trim panel trunk

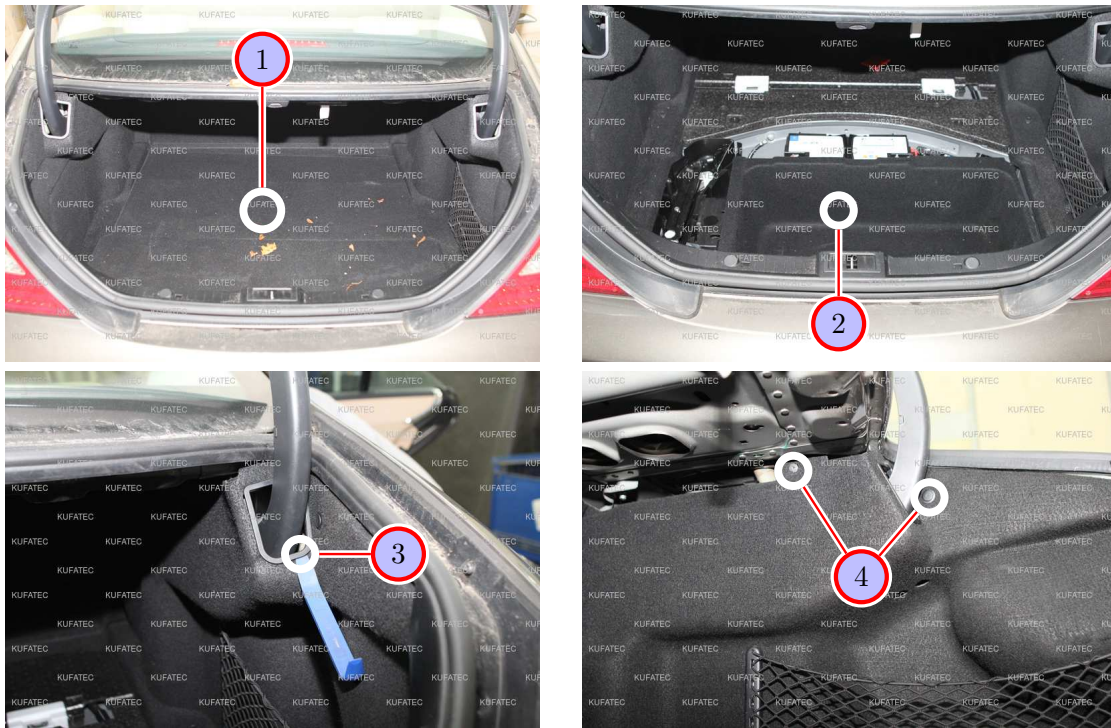

Figure 11: Removing trim panel trunk

Table 9: Removing trim panel trunk - instructions

Nr.	Work step	Note
1	Remove the trunk floor out of the trunk.	
2	Take the insert out of the spare wheel recess.	
3	Remove the marked covering using a trim tool.	
4	Loosen the marked plastic clips and move the lateral trim panel off above carefully.	

18 Cable routing to the underbody



Figure 12: Cable routing to the underbody

Table 10: Cable routing to the underbody - instructions

Nr.	Work step	Note
1	Pull the connecting cable further through in the trunk.	
2	Route the connecting cable behind the lateral trim panel down to the spare wheel recess.	
3	Pull the connecting cable further through and guide it through the marked grommet to the underbody.	
4	Pull the cable further through and guide it behind the heat protection plate in the wheel housing.	

19 Removing rear interior trim of the wheel housing passenger's side

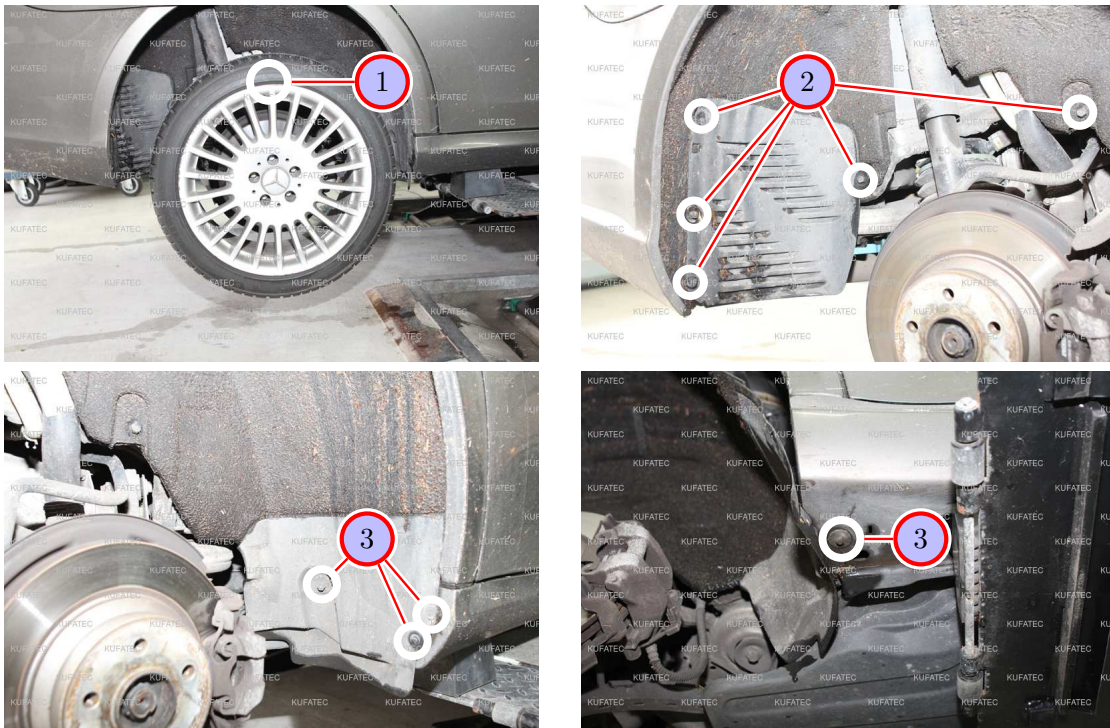

Figure 13: Removing rear interior trim of the wheel housing passenger's side

Table 11: Removing rear interior trim of the wheel housing passenger's side - instructions

Nr.	Work step	Note
1	Remove the rear wheel on the passenger's side.	
2	Loosen the marked plastic clips as well as the plastic nuts on the left in the wheel housing.	3x10er socket
3	Now loosen the plastic nut as well as the marked plastic clips on the right in the wheel housing.	1x10er socket
4	Afterwards loosen the marked plastic nut at the bottom and take the interior trim of the wheel housing out.	1x10er socket

20 Installation sound generator

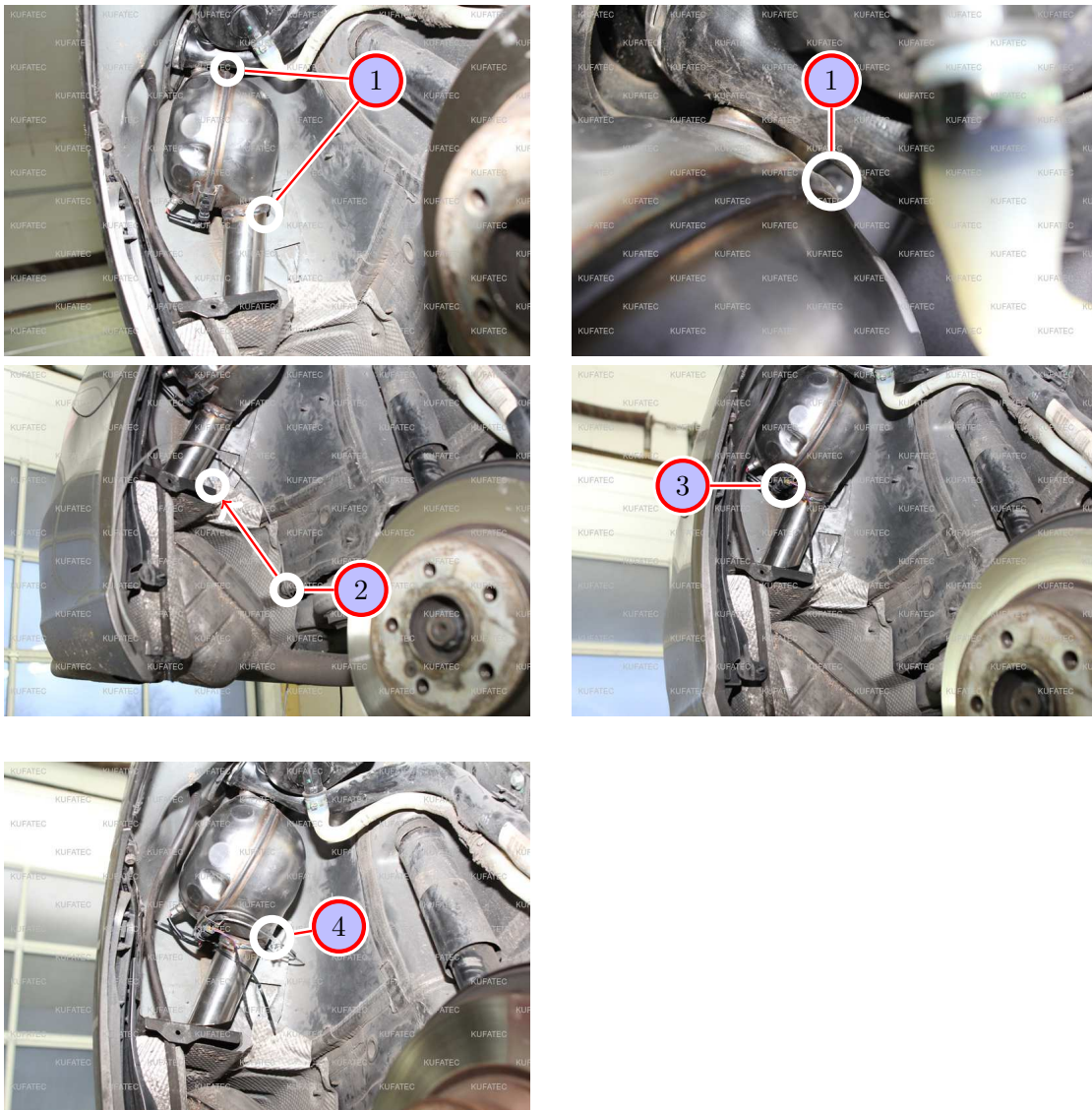

Figure 14: Installation sound generator

Table 12: Installation sound generator - instructions

Nr.	Work step	Note
1	Loosen the marked screw of the tank filler neck. Insert now the sound generator with the mounting plate at the bottom in the holding triangle and attach the sound generator at the top with the just loosened screw.	1x10er socket
2	Pull the connecting cable behind the heat protection plate up to the sound generator.	
3	Connect the connecting cable to the sound generator.	
4	Attach the delivered steel wire rope to the sound generator and a suitable position at the vehicle.	

21 Important Information Sound Booster

Please use for the fixation of the Sound Booster suitable high tensile screws. In order to avoid loosening of the screws by vibration please make the screws safe with appropriate factory material e.g Threadlock. Please additionally check the stability of the Sound Booster regularly and if necessary retighten the screws. In case of no consideration we do not assume liability for possible damages. After successful installation we recommend to cover the sound generator with a zinc spray. Make sure that you cover the opening of the sound generator so that no zinc spray can't get inside the sound generator.

As additional safety the delivered steel cable and the retaining clips have to be tightened on the Sound Booster as well as at a suitable position in the car. This safety cable is an additional security should the tightening screws should be released by vibration.

List of Figures

1	How to connect a cable to another	6
2	Cable Inscription	7
3	Vehicle overview	8
4	Removing trim panel driver's side / connection CAN High & Low	9
5	Removing trim panel center console	10
6	Connection ignition lead / ground	11
7	Installation pushbutton / placing control unit & module	12
8	Removing front trim panel passenger's side	13
9	Removing rear trim panel passenger's side	14
10	Cable routing to the trunk	15
11	Removing trim panel trunk	16
12	Cable routing to the underbody	17
13	Removing rear interior trim of the wheel housing passenger's side	18
14	Installation sound generator	19

List of Tables

1	How to connect a cable to another	6
2	Removing trim panel driver's side / connection CAN High & Low - instructions	9
3	Removing trim panel center console - instructions	10
4	Connection ignition lead / ground - instructions	11
5	Installation pushbutton / placing control unit & module - instructions	12
6	Removing front trim panel passenger's side - instructions	13
7	Removing rear trim panel passenger's side - instructions	14
8	Cable routing to the trunk - instructions	15
9	Removing trim panel trunk - instructions	16
10	Cable routing to the underbody - instructions	17
11	Removing rear interior trim of the wheel housing passenger's side - instructions	18
12	Installation sound generator - instructions	19